

PARTS
LIST

1000M Series Strap Dispensers

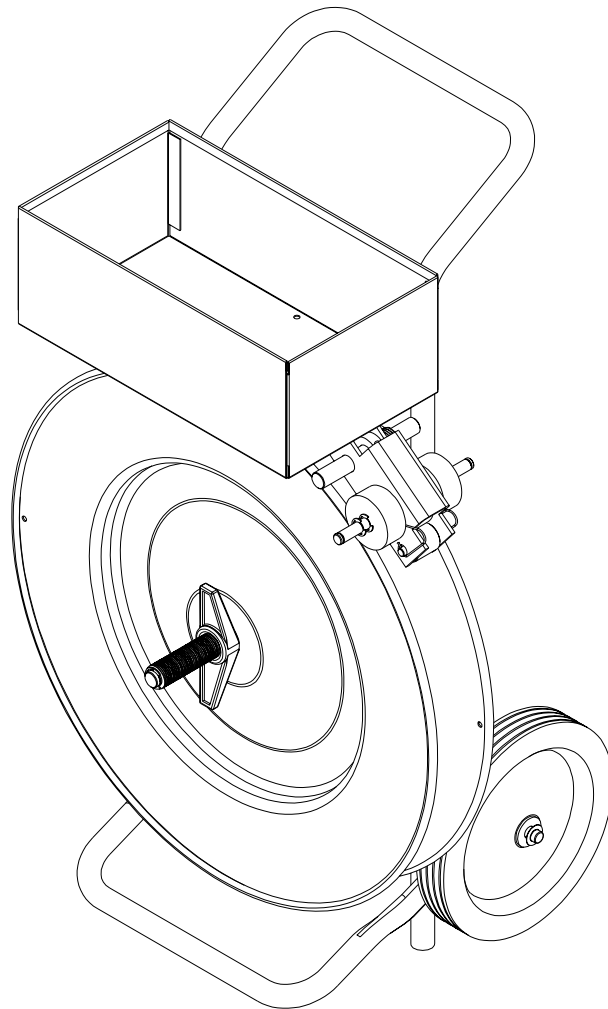

Strap Dispenser

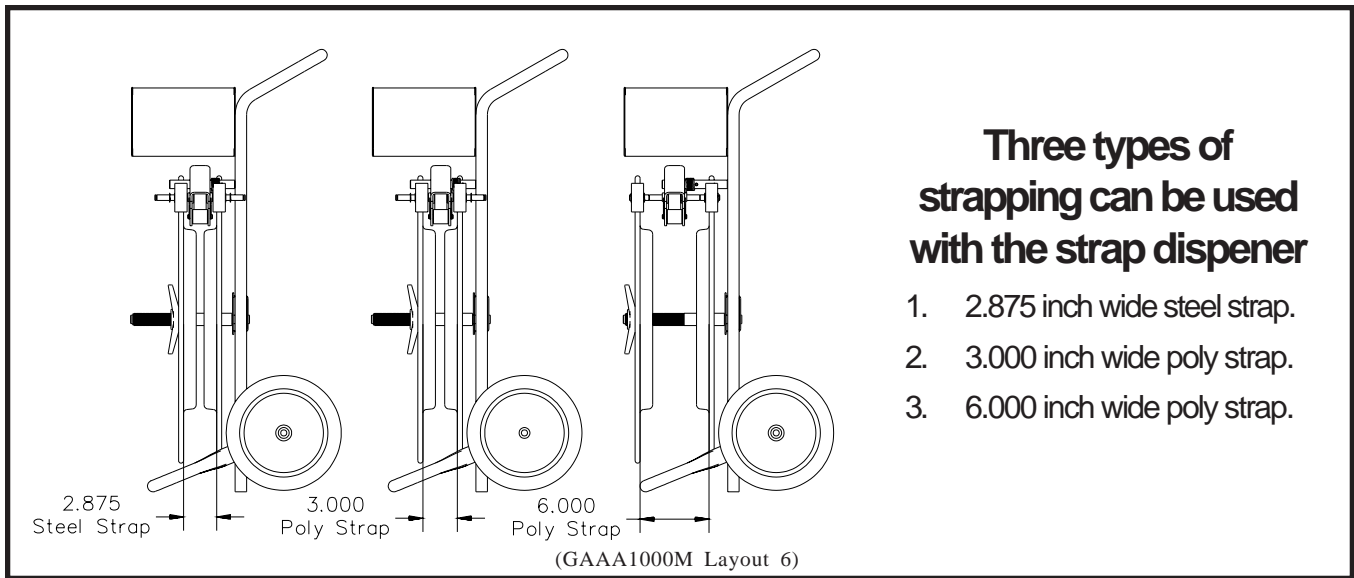

To change dispenser to use 6.000 inch wide poly strap

1. Remove E-ring and disc assembly

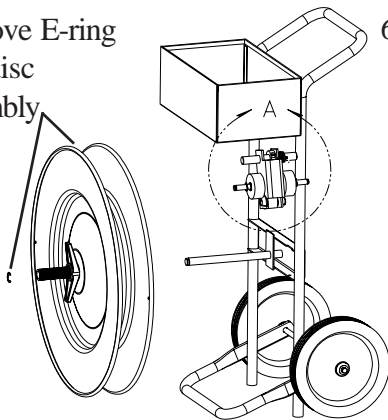

6. Reinstall disc assembly and E-ring onto dispenser

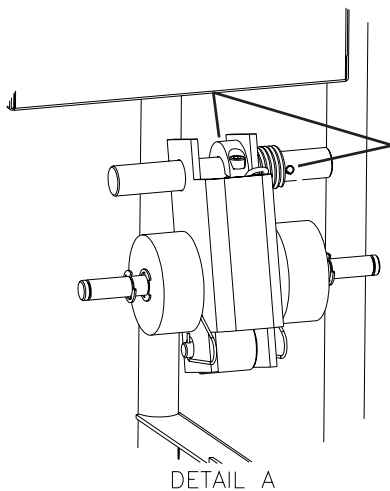
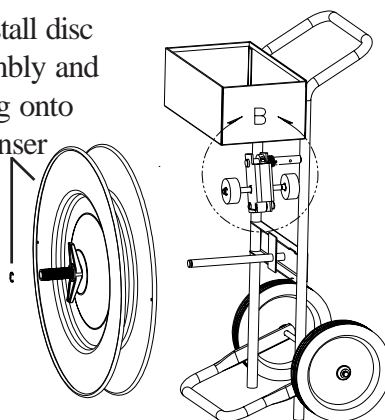

2. Loosen collar and remove roll pin

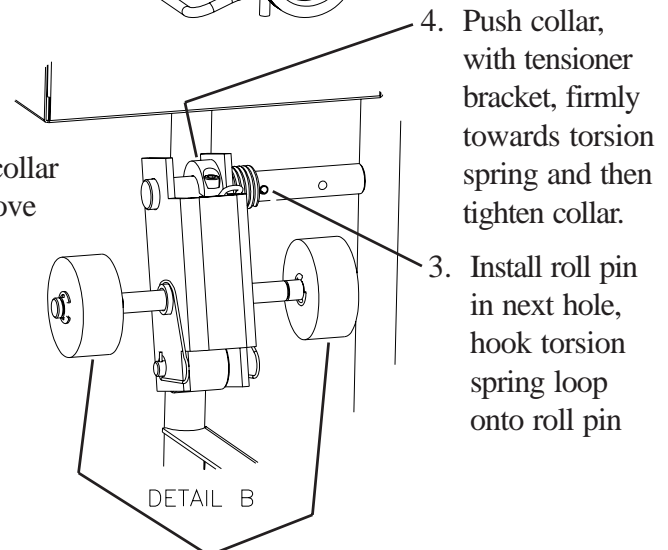

4. Push collar, with tensioner bracket, firmly towards torsion spring and then tighten collar.

3. Install roll pin in next hole, hook torsion spring loop onto roll pin

5. Move E-rings and rollers to outside positions of roller shaft as shown.

Parts List			
Item	Qty	Part Number	Description
1	1	GA1024	Wing Nut, 1.125-12
2	1	GA1018	Disc
3	1	GAA1018	Disc, Rear, Weldment
4	1	CBBB8000C	Kit, Roller Brake
5	1	CBBB8000A	Kit, Wheel

* All painted replacement parts are red.

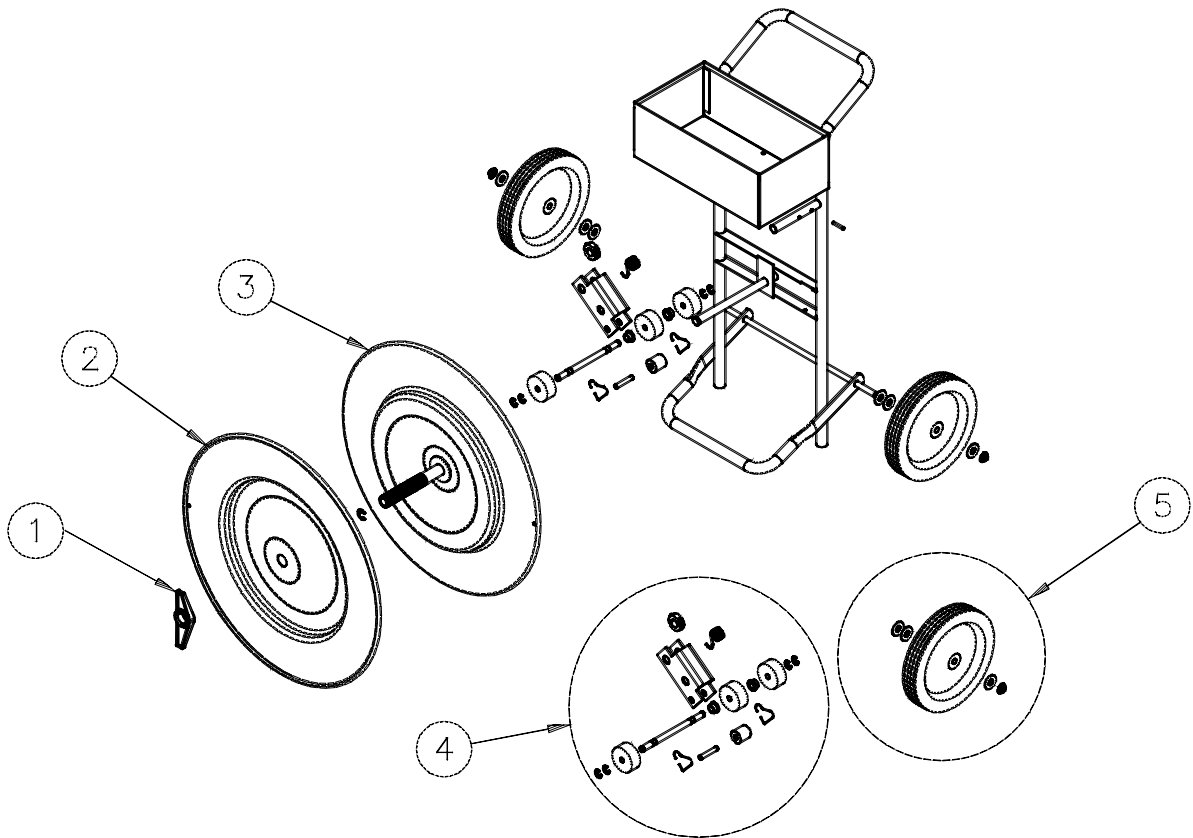

Strap Dispenser